



User's manual

Soft Touch Liner

Size 1, 2, 3





WARNING: AVOID SERIOUS INJURY FROM FALLING OR SLIDING OUT.
NEVER LEAVE CHILD UNATTENDED.
ALWAYS KEEP CHILD IN VIEW.
IMPORTANT: KEEP THESE INSTRUCTIONS FOR FUTURE REFERENCE.
A CHILD'S SAFETY IS YOUR RESPONSIBILITY.
ALWAYS SECURE CHILD IN THE RESTRAINT.
SECURE STRAPS TIGHTLY.
DO NOT SUBMERGE.

A

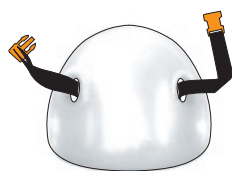

B

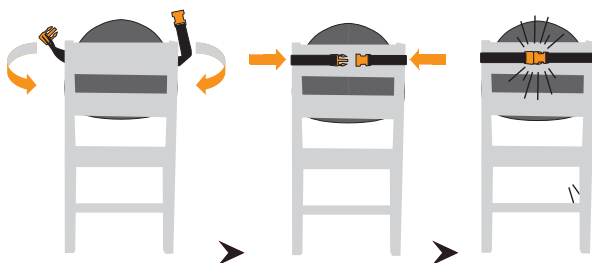
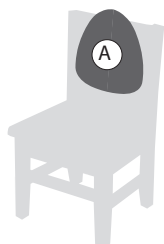
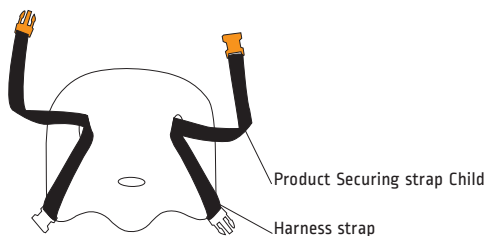

Secure product straps tightly around back of chair

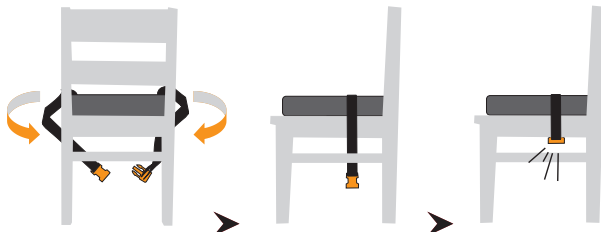
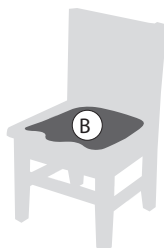

Secure product straps tightly around seat of chair

SPECIFICATIONS

SIZE 1,2,3

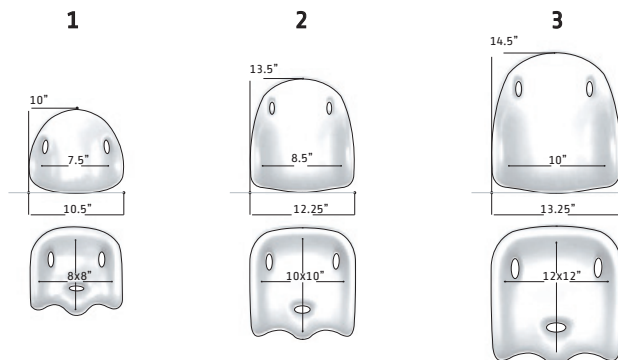

LIMITED WARRANTY

Bergeron by Design warrants to the original retail purchaser of the Special Tomato® product, that if any part or component proves defective in material or workmanship within five years of the purchase date, the defective part will be repaired or replaced [at Bergeron by Design's discretion] free of charge. Warranty service may be performed by an authorized service center or [at Bergeron by Design's discretion] the factory.

This warranty does not cover normal wear and tear, or damage caused by accident or misuse.

To exercise this limited warranty, the user should first obtain a Return Authorization Number from the dealer the Special Tomato® product was purchased from. The product must be delivered charges pre-paid [UPS recommended] to the factory or to an authorized service center, together with a copy of the original invoice, the Return Authorization Number and a written description of the problem.

MAINTENANCE & PRODUCT CARE

Special Tomato® Products are impermeable to fluids, but do not submerge. Use a mild detergent/cleaner to wipe the chair periodically.

To extend the life of the hook and loop strips, comb out the hook portion [hard side] to remove lint and other debris.

CUSTOMER SERVICE

Contact your dealer directly. Or contact the European Authorized Representative.

NOTICE

No part of this document may be photocopied, reproduced, transmitted, transcribed, stored in a retrieval system or translated to another language or computer language, in any form or by any means, electronic, mechanical, magnetic, optical, chemical, manual, or otherwise without the prior written consent of Bergeron by Design.

Use only Special Tomato® accessories and parts on Special Tomato® products. Special Tomato® parts are not interchangeable with other manufactures' products. Replace any worn parts immediately for safety. © Bergeron By Design



IMPORTANT- WARRANTY WILL BE VOID IF DEFACED OR REMOVED

Your Soft Touch Liner is guaranteed to be free from any manufacturing defects for a period of 5 years from the date of purchase under normal use and provided it is used in compliance with the operating instructions. This warranty extends only to the original retail purchaser and is only valid when supplied with proof of purchase. Please retain proof of purchase with this Limited Warranty.

Should a repair be needed please contact the retailer from whom the product was purchased.

PLEASE NOTE THAT THE WARRANTY WILL NOT BE APPLICABLE IF:

- A fault is the cause of misuse or poor maintenance.
- Repairs are carried out by a third party.
- The stroller is faulty due to general wear and tear which is the result of everyday use.
- A stroller is damaged as a result of an accident.
- The manufacturer is not satisfied that the stated warranty terms and conditions have been met.



MANUFACTURED BY:
BERGERON HEALTH CARE
15 SOUTH SECOND STREET
DOLGEVILLE, NY 13329

PRODUCT CODE:

PRODUCT DESCRIPTION:

COUNTRY OF ORIGIN:
USA

**AUTHORISED
EUROPEAN
REPRESENTATIVE:**

GLOBAL CARE LTD
ROSENWANGS ALLE 32
82603 WIRY J
DENMARK
TEL: +45 24 66 55 50
WEB: www.globalcarehba.com



Date: d.

Bergeron By Design
15 South Second Street
Dolgeville, New York 13329
T 1 315 429 8407
F 1 315 429 8862



© 2009 Bergeron By Design

The information contained herein is subject to change without notice.
Bergeron By Design shall not be liable for technical errors or omissions herein.